

3E

Hall Effect Current Transducer

Shenzhen 3E Sensor Co., Ltd. <http://www.3ese.com>



Type:	SZ132	100A	200A	300A	400A	500A	600A	1000A
Primary nominal Current RMS (I _{pn} Amp)		100A	200A	300A	400A	500A	600A	1000A
Primary current Measuring range (I _{pm} , Amp)		±300A	±600A	±900A	±1100A	±1200A	±1300A	±1500A

Electrical data

V _c Supply Voltage	±12V~±15V DC (±5%)
R _L Load Resistor	>1KΩ
V _{out} Output Voltage(analog)@±I _{pn}	±4V or 4-20mA
X Accuracy 1)@I _{pn} TA=25°C @ ±15V	±1%
ε L Linearity Error1) (@0... ±I _{pn})	±0.5%
VOE Electric Offset Voltage @I _p =0, TA =25°C	<±10mv
VOE Electric Offset Voltage@I _p =0, TA =25°C after 3* I _{pn} for 1 minute	<±10mv
TCVOE Thermal Drift of VOE TA =-25...85°C	<±1mv/°C
TCV _{out} Thermal Drift of V _{out} TA =-25...85°C	±0.05%/°C
T _r Response time	<3μ s
di/dt di/dt Accurately Followed	>50A/us
BW Band Width @-3db	DC to 50Khz
VIS Isolation Voltage@50Hz, 1minute	5KV
RIS Isolation Resistor@500VDC	>500MΩ
I _c Current consumption	<20mA

General data

T _A Ambient Operating Temperature	-25°C..+85°C
T _s Ambient Storage Temperature	-25°C..+85°C
M mass	200g
Housing	PA66+GS15%

3E reserves the right to carry out the modifications without prior notice

<http://www.3ese.com> Page 1 of 2

3E

Hall Effect Current Transducer

Shenzhen 3E Sensor Co., Ltd. <http://www.3ese.com>

dimension (mm)

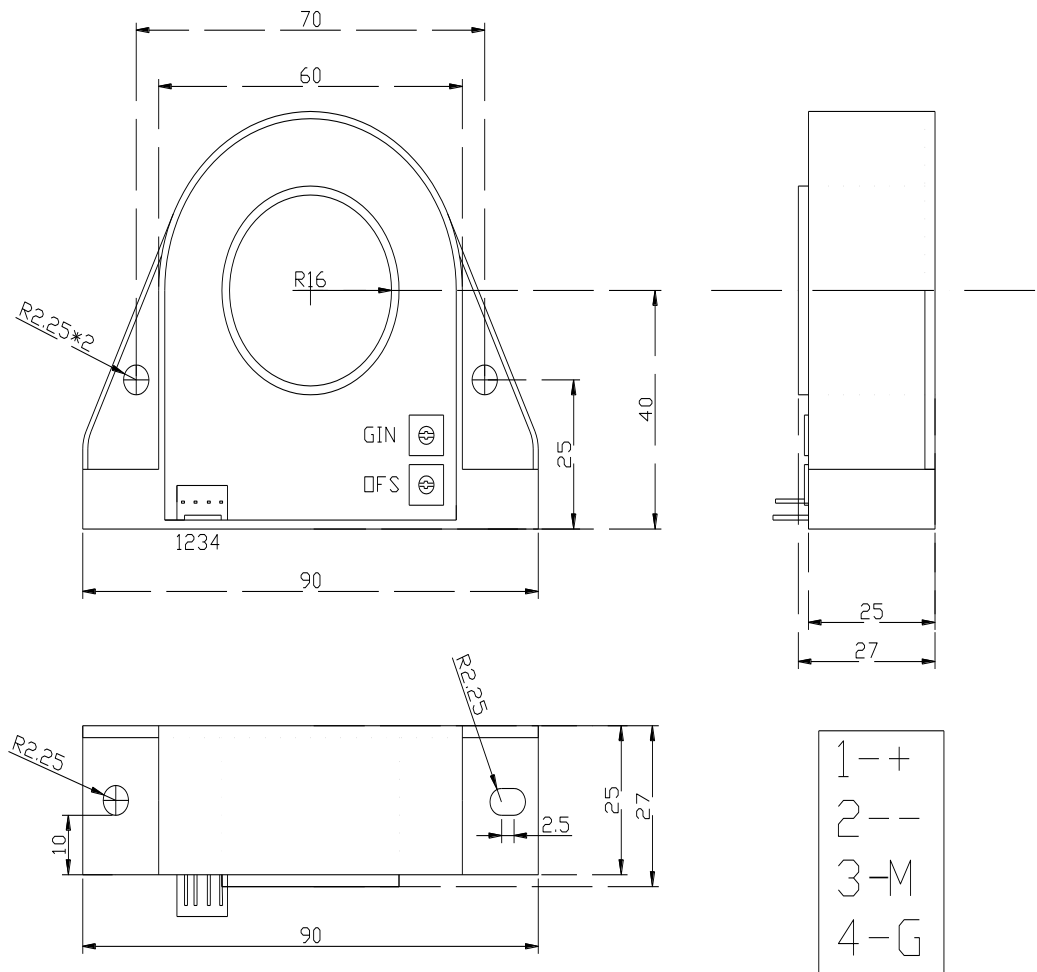

Mechanical characteristics

General tolerance: 0.5mm

Primary through-hole: ϕ 32mm

Connector: Molex 5046-04/A

3E reserves the right to carry out the modifications without prior notice

<http://www.3ese.com> Page 2 of 2